

# NIHONDAIRA YUME TERRACE



Learn about the rich history and cultural value of Nihondaira, set against the backdrop of some of Japan's most spectacular scenery.

Get blown away by the incredible 360° panoramic view overlooking Mt. Fuji and iconic spots including Suruga Bay, the deepest and most beautiful bay in Japan, Shimizu Port, Miho-no-Matsubara, Izu Peninsula, the Southern Alps, and more. Enjoy the ever-changing scenery of Mt. Fuji in different seasons; 24 hours, 365 days a year.

Learn about the fascinating history of Nihondaira on the 1st floor through interactive touch panels and informative displays. Make yourself comfortable in the lounge area on the 2nd floor. Prepare yourself before heading up to the observation deck, where breathtaking scenery fitting of its name "Yume Terrace" (Dream Terrace) awaits.

The stunning 360° open-air observation deck features gorgeous views of Mt. Fuji, Suruga Bay, Miho-no-Matsubara, and more.

Open till 9pm on Saturdays, so don't miss the chance to enjoy the breathtaking night views.

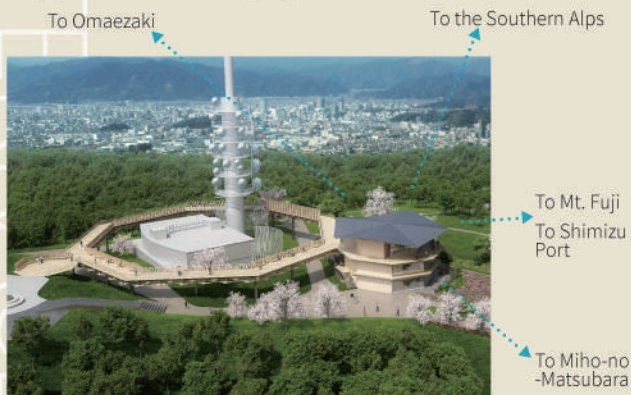

## Getting here



### 【 By car 】

- Approx. 30 min. from Shizuoka I.C. on Tomei Expressway
- Approx. 30 min. from Shimizu I.C. on Tomei Expressway
- Approx. 35 min. from Shin-Shizuoka I.C. on Shin-Tomei Expressway
- ※ Parking (free) 140 standard sized cars, 20 large buses

### 【 By Tokaido Shinkansen 】

- Approx. 25 min. by taxi from JR Shizuoka Station
- Approx. 40 min by bus from JR Shizuoka Station (North Exit, Bus Stop No. 11)
- ※ Take the Nihondaira Line bus heading towards Nihondaira Ropeway, alight at "Nihondaira Sekihi-mae" and walk for approx. 5 min.

### 【 By Tokaido Line 】

- Approx. 20 min. by taxi from JR Shimizu Station
- Approx. 10 min. by taxi from JR Higashi-Shizuoka Station
- Approx. 25 min. by bus from JR Higashi-Shizuoka Station (South Exit)
- ※ Take the Nihondaira Line bus heading towards Nihondaira Ropeway, alight at "Nihondaira Sekihi-mae" and walk for approx. 5 min.

600-1 Kusanagi, Shimizu-ku, Shizuoka-City 424-0886

TEL 054-340-1172 FAX 054-336-8222

Opening hours : Sun - Fri : 9am - 5pm

Sat : 9am - 9pm

※ The Observation Corridor is open 24/7

Closed on the 2nd Tuesday of the month and for New Year's Holidays (12/26 - 12/31)

Free Admission

HP <https://www.nihondaira-yume-terrace.jp/>

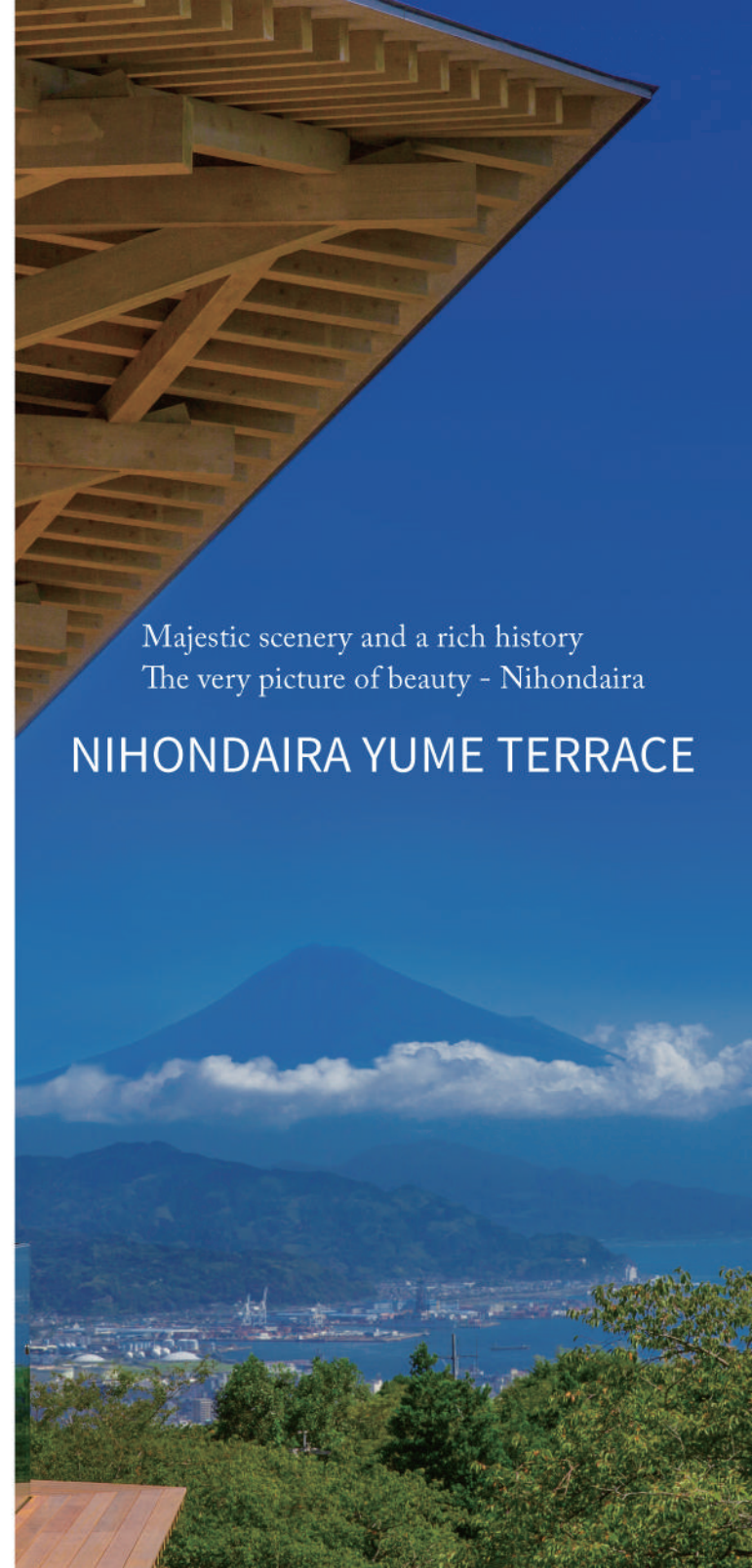

Majestic scenery and a rich history  
The very picture of beauty - Nihondaira

# NIHONDAIRA YUME TERRACE

## NIHONDAIRA YUME TERRACE

Learn about the rich history and cultural value of Nihondaira, set against the backdrop of some of Japan's most spectacular scenery.



View inside the facility



View of the corridor



Twinkling night view of Shimizu Port

### Introduction

The work of Kengo Kuma & Associates, using timber sourced locally from Shizuoka. A beautifully constructed facility designed with Mt. Fuji in mind. Kengo Kuma is an architect and the designer for the New National Stadium, the main venue for the Tokyo Olympics

### Information

#### 3F Observatory Floor

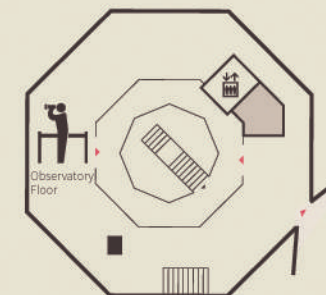

#### 2F Lounge (24 seats)

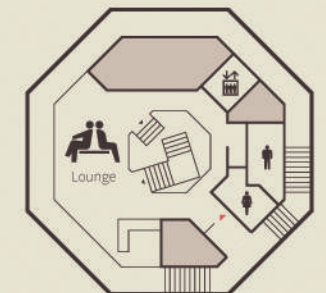

#### 1F Exhibition Area / Information

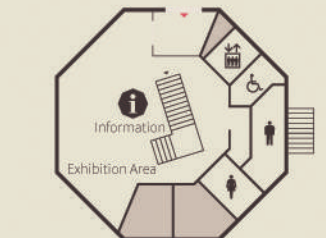

- Picture scrolls depicting Nihondaira's history
- Nihondaira's formation shown in 3D Projection Mapping
- Introduction of local sightseeing spots via touch panels

#### 【Garden】 Approx. 1,200m<sup>2</sup>

Features magnificent flowers bursting into bloom in different seasons

#### 【Observatory Corridor】

Observation deck stretching approx. 200m  
The stunning panoramic views of Mt. Fuji, Suruga Bay, Miho-no-Matsubara, Suruga Bay, Shizuoka City, the Southern Alps, and more